

**CHEMISTRY  
LIFE SCIENCE  
& SUSTAINABLE SOLUTIONS**

2022



AN  
**INTRODUCTION**  
TO GPE SCIENTIFIC



## LABORATORY EQUIPMENT SPECIALISTS

**LEADING  
BRANDS**  
DISTRIBUTED AND  
MANUFACTURED

### ABOUT US

GPE Scientific is an award winning leading manufacturer and distributor of Chemistry and Life Science laboratory equipment, including our energy efficient Sustainable Solutions portfolio of products and our specialised glass components for the industrial, laboratory and research markets.

We are the owner and manufacturer of the J Young range of research products including the J Young NMR valves and high vacuum greaseless stopcocks and also have our own team of highly experienced scientific glassblowers who can produce your specialised laboratory glassware requirements.

**established**

since 1962

**experienced**

over 50 years

**exclusive**

products available  
**only** from GPE

[WWW.GPESCIENTIFIC.CO.UK](http://WWW.GPESCIENTIFIC.CO.UK)

We are the exclusive distributor for the Chemglass range of laboratory equipment  
Supplying thousands of products to laboratories across the UK and Ireland

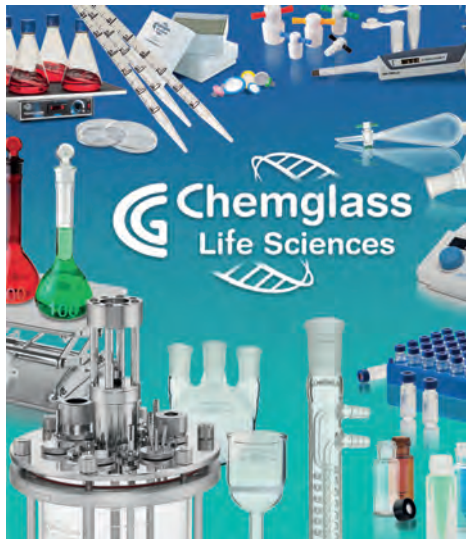

#### **CG-1318**

*Microcarrier spinner flasks promote optimal growth of suspension and microcarrier cultures. Indented bottoms, 100mL thru 1000mL, prevent accumulation of microcarrier beads under the impeller paddle. The complete system includes a flask with two angled sidearms and a PTFE paddle with glass shaft that adjusts through the compression fitting in the cap.*



#### **CG-1318**

*Adapters permit the connection of standard laboratory dram sample vials directly to the vapor tube or a bump trap of a rotary evaporator.*



#### **CG-1991-P**

*Reaction PIE-BLOCK is designed to fit directly on 135mm diameter circular top hot plate stirrers. Versatile design of the safety pie plate holder allows up to four pie wedges on one hot plate and securely locks them together.*



#### **Testimonial**



Sean Creedon  
Loughborough University

We purchased 15 complete 1,000mL Chemglass reactor systems from GPE Scientific for the new STEM teaching labs at Loughborough University.

We were kept thoroughly informed of delivery schedules in advance of the installation, which was carried out efficiently and without problem due to the professional way in which the technical staff at GPE Scientific work.

The technical support GPE Scientific have provided since the installation has also been first class, we would not hesitate to recommend GPE Scientific to others as a supplier of chemistry reactor systems.

## Filter Reactor

### CG-1959

The Jacketed filter reactors can be used for single or multistep reactions and filtrations in the same vessel and large scale peptide synthesis.

The filter base eliminates material transfers and significantly reducing losses.

The complete reactor system is supplied on the ChemRXNHub stand.



Process Filter Reactor, Complete, Electric Motor **1 Litre**

Process Filter Reactor, Complete, Electric Motor **2 Litre**

Process Filter Reactor, Complete, Electric Motor, Overall Height, W/Motor 74", Clearance Below Valve - 19.4" (Jacketed or Unjacketed) **10 Litre**

Process Filter Reactor, Complete, Electric Motor, Overall Height, W/Motor 73.8", Clearance Below Valve - 19.4" (Jacketed or Unjacketed) **20 Litre**

## Jacketed Reactor

### CG-1968

The Jacketed Process Reactors from Chemglass range from 10L to 100L cylindrical vessels.

The improved support clamp auto-centers reactor and lid allows quick installation/removal of reactor vessel.

The reactors can come with either an electric or air motor and have a variety of components and accessories which can be added to suit your needs.



Process Reactor, Complete, Air Motor, height with motor - 69", Clearance Below Valve - 15.3" with Manifold with M16 circulator fittings **10 Litre**

Process Reactor, Complete, Air Motor, height with motor - 69", Clearance Below Valve - 15.3" **20 Litre**

Process Reactor, Complete, Air Motor, height with motor - 81", Clearance Below Valve - 18.6" **30 Litre**

Process Reactor, Complete, Electric Motor, height with motor - 92.8", Clearance Below Valve - 10.2" **100 Litre**

## Benchtop Reactor

### CG-1949-X

The ChemRXNHub™ process systems are complete with benchtop stand, overhead stirrer and glassware.

Ranging from 300ml to 5L vessels.

Available with the optional manifold connection and heat transfer fluid draining system.

The unique design of the ChemRXNHub™ support stand and clamping system allows for quick and easy installation/removal of glassware and fits into most benchtop hoods.

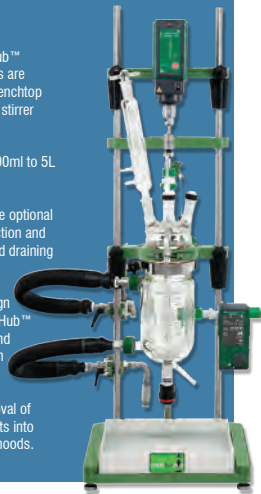

ChemRXNHub Process System, Complete w/ glassware and stand, digital overhead stirrer **300 ml**

ChemRXNHub Process System, Complete w/ glassware and stand, manifold/ drain system with digital overhead stirrer **500 ml**

ChemRXNHub Process System, Complete with Glassware and Stand, Manifold/Drain System **2 Litre**

ChemRXNHub Process System, Complete w/ glassware and stand, manifold/ drain system with removable remote **5 Litre**

## NEW - 50 & 100L "Squatty" Process Reactor

With NEW 400mm Flange  
NEW Squatty Design

CG-1968-W9100

Complete 100L Squatty Reactor System Features:

- More Clearance:  
100L Squatty Glass Reactor System with 400mm Flange Maximizes Clearance Under The Drain Valve
- Wider Access:  
400mm ID Flange Provides Wider Access For Insertion or Probes, Baffles and Other Accessories without Interfering with Agitators
- Heavy Duty:  
2" Diameter Solid Stainless Steel Uprights and Heavy Duty PTFE Coated Aluminum Fittings Provide Maximum Strength and Chemical Durability
- Digital Temperature Monitor
- Heavy Duty Chemically Resistant Frame:  
Universal Motor Mount for Electric, Air, or XP Motors: Design Provides Greater Accessibility



## CHEMRxnHUB Dual & Triple Support Stands



**CG-1949-X DUAL**

**CG-1949-X TRIPLE**

This unique stationary reactor stand is designed to fit into most benchtop hoods.

The stand provides support for the Reaction Vessel(s), Glassware, Overhead Stirring Motor, and Temperature Monitor and the unique design allows easy removal/installation of the glassware.

The stand also includes a removable spill tray.

## Reactor Accessories



CG-1968-A-01



CG-1968-B

## NEW Zero Dead Space Valve



CG-1968-Q

## RX-10 Reactor Control - Enhance the Jacketed Lab Reactor

The RX-10 provides an interface connecting any type and volume of jacketed reactors to cryostats, thermostats, stirrer motors, and sensors. Allowing researchers to precisely control and monitor chemical reactions and processes in the lab or kilo lab environment

The intuitive touchscreen automates the most commonly used unit operations, such as heating, cooling, dosing, pH measurement, and sampling.

For more demanding processes, control capabilities can be extended using the computer-based iControl software which offers programmable reaction sequences including parallel parameter control. This facilitates process scale-down/scale-up with realistic conditions, remote monitoring, reporting, and seamless integration with Process Analytical Technology (PAT) tools.

By offering repeatable controlled conditions for dosing, pH, or temperature profiles, RX-10 enables improvements in yield, selectivity, and product quality.

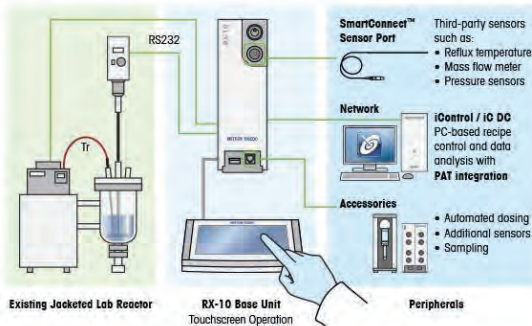



With the new **MAGIO series**, JULABO is expanding its product portfolio of high-end bridge mounted circulators, refrigerated and heating circulators

# Julabo

THE TEMPERATURE CONTROL COMPANY

We are pleased to offer the full Julabo range of Temperature Control Systems and accessories.

Today Julabo is an industry leader and has played a significant role in the development of fluid-based temperature control.

The team of expert engineers and technicians at Julabo help shape the market with new ideas and innovations.

**Heating  
Circulators**

**Presto  
Temperature Control**

**DYNEO  
Heating Immersion Circulator**

**Recirculating  
Coolers**

**CORIO New generation of  
laboratory circulators**



WWW.GPSCIENTIFIC.CO.UK



# huber

Inspired by temperature

Huber are the technology leaders for high precision thermoregulation solutions in research and industry.

We are proud to offer the full range of Huber units which complement our complete reactor systems.

The Huber range ensures precise temperature control in laboratories, pilot plants and production processes throughout the whole world – from  $-125^{\circ}\text{C}$  to  $+425^{\circ}\text{C}$ .

Besides dynamic temperature control systems, Huber develop and produce chillers as well as classic heating and cooling circulators.



Grande Fleur

## Heating Immersion Circulators



## Unistat Range



## Hotbox Heating Circulators



## Unichillers



## Heating Baths



## Dynamic Temperature Control Systems







First to market  
Energy efficient  
Safer and cheaper to run.

Working with the University of Cambridge, Genlab has developed units that represent a novel, sustainable solution to glassware drying. In addition they're much easier to use.

### Key features

- Fully insulated with adjustable vent cover
- Integral 7 Day timer with display
- Digital controller with fixed over-temperature safety cut-out
- Adjustable shelf runners with removable chrome shelves
- Lockable castors on the 425 and 885 litre models
- Easy clean powder coated body with toughened glass doors

### Benefits & Cost Savings

- Low energy consumption - **50% lower than traditional cabinets**
- Low heat output - reducing air conditioning costs
- Fully insulated - safer for end users
- Easy, specific temperature controller
- Integral programmable 7 day timer - ON/OFF to reflect your needs
- Convection or fan - heat up time < 1 hour



E3 fan units are able to remove approximately double the moisture of a convection unit, the time taken to dry a load is therefore halved.

As a result the energy used to dry a load is actually lower for a fan unit compared to a convection unit.

E3 is our market leading brand for scientifically developed, cutting edge, sustainable, eco-friendly products.

Whether you are a single laboratory needing to buy greener and smarter, or a larger organisation concerned with reducing overall running costs, Genlab E3 can provide the solution that's best for you.

IWC-425



IWC-885



IWC-200



IWC-100



GPE Scientific are proud to be working with Nanalysis to be the exclusive UK and Ireland supplier of the NMReady™ portable benchtop **NMR spectrometer**.



The powerful 100e is based on the world's strongest compact NMR magnet platform - 2.35T (corresponding to 100 MHz 1H NMR!)

Our revolutionary benchtop NMR spectrometer, the NMReady-60, allows chemists, researchers, engineers, and students to perform spectroscopy tests wherever and whenever they need.

Whether you are in the lab or in the field, the NMReady-60 portable NMR gets you the spectroscopy data at your point of need.

**NMReady 60 Pro**

**NMReady 60e**



The instrument's supported nuclei are 1H, 7Li, 11B, 13C, 19F and 31P (dual mode).

The instrument's supported nuclei are 19F, 1H and Dual Mode (19F and 1H).

SIMPLE OPERATION

•

EASY-TO-INSTALL

•

SAFE, ACCURATE AND FAST

## Introducing the affordable, easy-to-use **AUTOsample-60**

The AUTOsample-60 mounts on top of any NMReady-60e or 60PRO for painless interconversion between autosampler and manual mode, while still maintaining the notably minimal footprint.

Data acquisition and processing is controlled at the touch of a finger through the onboard software.



# NORELL®

## Precision NMR/EPR Tubes & Accessories



GPE Scientific is the exclusive UK and Ireland distributor of Norell NMR Tubes. We supply the full range of NMR Tubes and accessories including the popular range of Select Series tubes specifically designed for high resolution NMR and the Standard Series for auto-sampling and high throughput NMR.

We realise that the last thing you want is to repeat a run because of shimming problems caused by a faulty NMR tube. Or worse, during use, your tube ends up breaking because of poor tube dimension.

With Norell NMR tubes you are guaranteed superior quality and remarkable performance.

### Standard Series - Class B Glass



5mm Ultra-Precision, High-Precision and Precision NMR Sample Tubes  
5mm Economy High-Throughput NMR Sample Tube  
10mm Ultra- Precision and Precision NMR Sample Tubes  
10mm Economy NMR Sample Tubes

### Select Series - Class A Glass / Pyrex



5mm Ultra Precision NMR Sample Tubes  
3mm Ultra Precision NMR Sample Tubes  
3mm High-Throughput NMR Sample Tube  
10mm Ultra Precision NMR Sample Tubes

### Secure Series - Available in Class A / Class B



5mm Ultra-Precision NMR Sample Tubes Secure Series  
3mm Ultra-Precision NMR Sample Tubes Secure Series  
5mm Ultra-Precision, High-Precision & Precision NMR Sample Tubes  
5mm Economy High-Throughput NMR Sample Tubes

### Special Purpose



Constricted NMR Tubes  
Amberized NMR Tubes  
Screw-Cap NMR Tubes  
Heavy Wall and Medium Wall NMR Sample Tubes  
Bruker MATCH™ System NMR Sample Tubes

### Sample Vault



Sample Vault Series NMR Tubes  
Medium Wall and Heavy Wall Sample Vault Series™ NMR Tubes  
Sample Vault™ Caps for the Sample Vault Series  
Closures to Seal the NorLoc Open Port Caps



## J Young

GPE Scientific manufacture  
Vacuum Manifolds / Schlenk Lines  
on site using the official J. Young  
High Vacuum PTFE valves.

The J Young high vacuum greaseless  
stopcocks incorporate three Viton  
O-ring seals (one encapsulated in PTFE)  
on a standard PTFE piston.

Our stopcocks are leak tested to better than  
10-6 ltr/sec and are suitable for use in  
applications up to 7 PSI.

Alternatively these can be manufactured  
with glass stopcocks.

### J. Young NMR Valve with Tube Attached

Handle your NMR sample without  
flame sealing your tubes.

Teflon covered O-Ring eliminates material  
incompatibilities and completely greaseless Teflon  
assembly means the tube is easy to use and to  
disassemble for cleaning.

Includes female joint for quick attachment  
to your vacuum rack.

Available in  
Beige,  
Blue,  
Green,  
Orange,  
Red  
and Yellow.

### REDUCED LENGTH NMR TUBE WITH J. YOUNG VALVE NOW AVAILABLE



Available lengths  
5 inch  
7 inch  
8 inch



# SCHLENK LINES

**General Purpose Bank  
Manifold**



**General Purpose Single Bank  
Manifold with Vacuum Gauge**



**Space Saving Manifold**



**Dual Bank Manifold**



**Dual Bank Manifold  
with Oblique Valves**



**Dual Bank Offset  
Manifold**





## Technology for Vacuum Systems

VACUUBRAND manufactures the most comprehensive range of vacuum pumps, gauges and controllers for rough and fine vacuum for laboratory use.

The modular vacuum systems comply with the technical and economical requirements for vacuum generation and also ecological criteria in outstanding degree.

### Diaphragm pumps

The VACUUBRAND diaphragm pump line includes pumps with a wide range of flow rate and ultimate vacuum.

- Single-stage diaphragm pumps reach as much as 70 mbar (absolute) vacuum.
- By connecting pump heads in series of two, three or four stages, we can create pumps with ultimate vacuum reaching 0.3 mbar on some models.
- Connecting the heads in parallel produces higher flow rates.



### Vacuum gauges and controllers

VACUUBRAND offers a comprehensive range of electronic measuring instruments for laboratory and industrial use, as well as controllers for rough and fine vacuum to regulate from atmospheric pressure down to 10-3 mbar.

Modern vacuum gauges and controllers in laboratory and industry must meet high requirements.

Consistent chemical resistance in the wetted area

Plug and play - tailor-made and easily configurable components due to VACUU-BUS®

Open interface architecture for system integration



### Chemistry diaphragm pumps and -pumping systems

Our chemistry diaphragm pumps are available in a full range of volume flow rates and ultimate vacuum options.

- Single-stage models reach as much as 70 mbar (absolute) vacuum.
- Connecting pump heads in series as two-, three- or four-stage pumps improves an ultimate vacuum to as much as 0.6 mbar.
- Connecting heads in parallel provides higher flow rates.
- Our line offers combinations that satisfy virtually any laboratory need.



VACUUBRAND pumps combine these options to create pumps with the capabilities you need for most applications.

## NEW VACUPURE PUMP

10-3 mbar vacuum range  
100% oil-free  
No abrasion  
No wear parts

VACUU-PURE reliably delivers the benefits of oil-free vacuum technology in the pressure range of 10-3 mbar. The special design with two cantilevered spindles and a magnetic gear allows hydrocarbon-free operation. The unique design of VACUU-PURE gives it an exceptionally high condensate compatibility, making a gas ballast unnecessary even at high vapor loads. The spindles run contact-free and are thus free of abrasion.



## Fluid aspiration systems

Safe, sensitive and efficient aspiration of supernatants in all application areas.

- The BVC basic is intended for connection to an external vacuum source.
- The BVC control and the BVC professional are equipped with a high performance, chemically resistant diaphragm pump.
- The vacuum level and thus the suction force at the hand control can be sensitively adjusted via a touch panel.
- In addition, the BVC professional features a non-contact liquid level sensor and self-closing quick couplings (4l PP bottle version).
- All systems are available either with a vacuum-resistant, autoclavable 4l PP bottle or with a 2l borosilicate glass bottle, e.g. for working with aggressive disinfectants such as chlorine bleach.



## Rotary vane pumps and chemistry-HYBRID pumps

Rotary vane pumps are used whenever it is necessary to have a process vacuum of up to 10-3 mbar. VACUUBRAND rotary vane pumps are high-performance, yet compact, and can be equipped with an extensive line of VACUUBRAND accessories.

They have an innovative lubrication system with a built-in oil pump and have a large oil volume. This extends oil change and service intervals and protects the pump at start-up. The effective gas ballast feature, with its high-flow gas ballast, provides high vapor pumping capability for water and solvents.



## NEW & UNIQUE to GPE - High Vacuum Pump Trolley

Designed to maximise space and provide flexibility in the lab  
Vacuum pump is attached to the baseplate securely using anti vibration feet - bespoke fixing points available so our unique base plate can be matched to any pump  
Reinforced, lockable fixings for the Cold Trap  
Easy to transport around your laboratory, preventing the need to dismantle and reassemble elsewhere  
All parts available individually or as part of a package  
Polypropylene trolley with stainless steel baseplate







## Benchtop Equipment



GPE Scientific have partnered with Scilogex Benchtop Equipment to bring you the latest in precision laboratory equipment.

Exclusively offering this wide range of products throughout the UK and Ireland we are able to supply your laboratory with high quality Life Science items such as Multi-Purpose Centrifuges, Liquid Handling products, Hotplates, Stirrers, Mixers and Rollers and many more fantastic items.



### Hot Plates

Multi Position

The MS-H-Pro-T features an independent back-lit LCD display for both heat, stirring and timer functions and PID technology. The hotplate will heat at the target temperature for the set time period and automatically turn off.

### Magnetic Stirrer

Multi Position

Scilogex offers simple multi-position stirrers that simultaneously stir up to 10 or 16 solutions (depending on the model) at room temperature. A 10-position model also heats as well as stirs. Anti-slip mats guard are both chemically resistant and easy to clean.



### Microplate Mixer

Multi Purpose

Compact and universal Microplate Mixer can hold one or two microplates, used in life science fields including microbiology, cell and molecular biology, immunology and biotechnology.

### Digital Shakers

Orbital & Linear

Orbital and Linear Digital Shakers provide smooth and quiet motions for mixing in culture dishes, flask and beakers.

LCD Digital shakers from Scilogex incorporate a timer, allowing the user to specify the length time required for agitation, and therefore to leave the unit unattended during this time.



### Centrifuges

Multi Purpose

The accuracy and sturdiness of Scilogex centrifuges allows them to be used in a multitude of applications, including pelleting of DNA and RNA samples, pelleting of PCR amplified nucleic acids, separation of antibody and protein precipitates, performing enzymatic tests, removing cell debris from cell homogenates, PRF and achieving bacterial and yeast cell fractionation.



### Vortex Mixer

SCIOLOGEX Vortex Mixers are ideal instruments for mixing liquid components in tubes, resuspension of cells, using an eccentric mechanism. They are widely used in biological and chemical analysis applications.



### Liquid Handling Equipment

The introduction of a large Liquid Handling range has seen a growth in our Life Science market offering everything from Pipette fillers and controllers to Bottle top dispensers and Multichannel pipettes. This means the new Sciologex line has successfully begun to meet the needs of scientists offering high precision instruments which can be used to reliably measure, transfer and dispense a range of liquids for a number of working applications.



**SCIOLOGEX**

### Rotary Evaporators

Main Features:

- Easy to read large digital LCD display shows temperature, rotation speed and timer
- Large 5L heating bath with a temperature range of ambient to 180°C
- Patented condenser (cooling surface 1,500 cm<sup>2</sup>) provides excellent cooling
- Motorized lift with safety automatic release of the evaporating flask to the top position in case of power failure
- Speed range from 20 to 280 rpm
- Timer function for precise control processing
- Chemical-resistant PTFE seals and patented pressure springs provide excellent sealing
- PC control and documentation of all parameters via USB (using third-party software)
- Precise temperature control and adjustable safety circuit
- Quick release connectors for easy flask removal



### Overhead Stirrers

- High reliability, long continuous service, outstanding performance
- Cover the speed range from 50 to 2200rpm - Pro, and 0 to 2200rpm - S - the speed is accurate and controlled
- Brushless DC motor drive, low noise and maintenance free
- Overload protection – motor would automatically stop in case of continuous overload
- Anti-spill samples-PC control system starts up smoothly, prevent samples overflow



# IC Biomedical (formerly Taylor-Wharton) Cryogenic Storage Solutions

Cryogenic storage for long term applications in medical, scientific, biobanking and industrial applications. Taylor-Wharton Cryogenics is a leading manufacturer with over 40 years of experience in the design and production of cryogenic storage vessels for liquefied gases.



Specialists in the design and manufacture of industrial and educational laboratory fume cupboards.

Entirely custom builds available - please contact us to discuss your requirement.



## Energy Saving Products for your Laboratory.



**LIEBHERR**



Refrigerators and freezers for the research and laboratory sectors have to fulfil extremely demanding criteria.

With precise electronic controls and degree-accurate temperature settings, Liebherr laboratory appliances, distributed throughout the UK and Ireland by GPE Scientific Ltd are able to offer outstanding temperature stability.

Their comprehensive functions and features ensure that sensitive substances, chemicals, and other research materials can be optimally stored.

**MERCK**



Our Lab Water purification system portfolio offers a broad range of pure and ultrapure water purification systems and services designed for scientists working in pharmaceutical, clinical, academic, industrial, research, and government laboratories, in both validated and non-validated environments.



## REAL-TIME PCR

The MyGo Pro provides unmatched performance in a convenient format.

Novel Full Spectrum Optics deliver 120 optical channels of fluorescence data from every tube for exceptional multiplex PCR.

High performance Peltier elements, combined with solid silver blocks, provide both speed and proven world-leading thermal uniformity.

Performance made easy...

## Logicall Wireless Solutions



Logicall Wireless Solutions offers a range of monitoring solutions aimed at saving organisations time and money through automation.

Logicall Enterprise is our Scalable IoT Solution for Monitoring Critical Assets and Environments. Our selection of Long Range (LoRa) sensors allow us to build tailored solutions perfectly suited to your business needs.

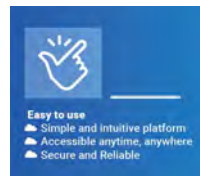



Best Seller

In Stock

Supply,  
install and  
commission  
in 72hrs

The Labogene range of Class II safety Cabinets provide microbiology safety cabinets of innovative design, superb construction and unsurpassed reliability. The cabinets employ energy saving and environmentally friendly components to produce the finest LAF and Biological Safety Cabinets.

Using the latest energy efficient fans, lower energy consumption also results in less heat transmission, both into the work chamber and out in to the laboratory, contributing to significantly reduced overall costs.

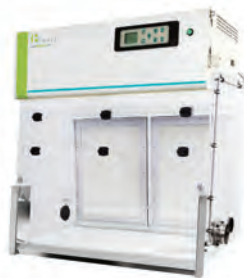

Bigneat is an established world-leading designer and manufacturer of ductless fume hoods, laboratory safety cabinets, enclosures and clean air systems for protection from chemical fumes, powders and biological hazards.

Applications for Bigneat products embrace operator and process/sample protection during laboratory procedures, batch and on-line production processes.

"The world's No 1 manufacturer of enclosures for laboratory automation"



**A&D's core technology of analogue and digital conversion enables us to understand and utilise information within the environment.**

---

With this competency, we provide tools using precision measurement and controlling technology and assist customers to create added value and contribute to the development of industry and healthy living.

A&D electronic balances provide a weighing performance that is very reliable, accurate and provides great value.







**ARCTIKO PF 700®**

Biomedical Freezer with glass door

UPRIGHT CAPACITY 628

L RANGE -10 / -23 °C

The PF 700 freezer -23°C is suitable for pharmacies due to the flexible interior and different options of shelves and drawers or a combination of those.

It is user-friendly because of the adjustable shelves, a reversible door as well as automatic defrost and automatic door closing.

The PF 700 freezer has a glass door, which allows the best overview of the inside. Furthermore, the advanced Arctiko controller ensures a stable temperature and it is equipped with many alarms, which all come as standard.



**ARCTIKO CRYO 230®**

Cryogenic freezer

CHEST CAPACITY 233

L RANGE -150 /-140 °C

The CRYO range features a dual cooling system comprised by two independent systems offering double security.

In the unlikely event that one cooling system should fail, the second cooling system will maintain the freezer at -130°C.

The CRYO 230 offers a wide variety of research and long-term storage applications for low temperature scientific experiments, preservation of cells, DNA, bone material, bacteria, etc.

With its superior cooling precision and features, the CRYO 230 the perfect choice for testing special material, ideal for hospitals, university laboratories, military industry or sanitation stations.



**ARCTIKO ULUF 590-2M®**

Ultra Low Temp. Freezer - Double Security

UPRIGHT CAPACITY 556 L

RANGE -90 / -40 °C

The ULUF 590-2M freezer -90°C features our dual cooling system, that consists of two independent systems offering you the best security. In case of any failure with one of the cooling systems, the other system will still maintain the temperature at -80°C.

Thereby, your samples will not be affected by any challenge caused by an unexpected system failure, until service is provided.

This is possible due to our highly reliable single compressor technology.



**GN INOX**  
Nitrogen generators

#### GN INOX

A Nitrogen generator designed to guarantee a constant, pure (up to 99.999%) flow of gas for any application where a particular attention to hygiene is requested, besides the extremely high gas quality.

For this reason, the Nitrogen generator GN INOX, thanks to its stainless steel finishing, can be sanitized with standard procedures and can be integrated into MAP packaging machines or used in sterilized environments for pharmaceutical production.



**GALILEO**  
Nitrogen generators

#### GALILEO NITROGEN GENERATORS

Work in complete autonomy, producing only the requested amount of gas with no waste.

GALILEO is available in five models with different flow rates and different purity levels, to satisfy every laboratory's need.

One of the unique advantages of GALILEO generators is the modularity, which allows users to increase production in case of need, simply by adding one or more modules.



**GEMINI**  
Oxygen generators

#### GEMINI OXYGEN GENERATORS

Use the PSA technology to produce a continuous pure Oxygen flow, without the use of chemicals.

The GEMINI generator requires just electric current and compressed air to produce Oxygen.

One of the unique advantages of GEMINI generators is the modularity, which allows users to increase production in case of need, simply by adding one or more modules.



**ORION P-SERIES**  
Pure air generators



**MARS**  
Hydrogen generators

#### MARS HYDROGEN GENERATORS

Use PEM technology (Proton Exchange Membrane) which allows the production of compressed, extremely pure Hydrogen without the need for external purification nor compression systems.

MARS Hydrogen generators are just fed by distilled water and electric current, no caustic solutions are used.

MARS Hydrogen generators don't require any maintenance and are safe and reliable.



**ORION Z-SERIES**  
Zero air generators

#### ORION Z-SERIES

Zero air generator produces a continuous flow of air with a minimum content of hydrocarbons, directly on site without any waste.

#### ORION P-SERIES

Pure air generator produces pure, hydrocarbon free and dry air, with a very low dew point (-50°C).

General plant research applications  
Plant pathology research  
Arabidopsis research

Drosophila research  
Entomology  
In vitro plant growth studies

Plant tissue culture  
General incubator applications  
Seed germination studies

## PLANT GROWTH CABINETS



Hettich Benelux - PRC 1200 WL\*

- Exterior dimensions: 905 x 1295 x 2050 mm (w x d x h).
- Internal volume: 968 liters.
- Exterior / Interior: white / stainless steel white coated.
- Humidity system: ultrasonic (optional).
- Growth area: 3 shelves (875 D x 625 W mm = 1.65 m<sup>2</sup>).
- LED's : 200  $\mu$ Mol, 400  $\mu$ Mol or 1100  $\mu$ Mol.
- Growth height at 3 LED layers: 400 mm



Hettich Benelux - PRC 1200 SL\*

- Exterior dimensions: 910 x 1295 x 2050 mm (w x d x h).
- Internal volume: 968 liters.
- Exterior / Interior: white / stainless steel white coated.
- Humidity system: ultrasonic (optional).
- Growth area: max. 15 shelves (875 D x 625 W mm = 9 m<sup>2</sup>).
- LED's : 200  $\mu$ Mol (optional 400  $\mu$ Mol)



Hettich Benelux - PRC 1700 WL\*\*

- Exterior dimensions: 2070 x 950 x 2070 mm (w x d x h).
- Internal volume: 1522 liters.
- Exterior / Interior: white / stainless steel white coated.
- Humidity system: ultrasonic (optional).
- Growth area: 3 shelves (600 D x 1300 W mm = 2.34 m<sup>2</sup>).
- LED's : 200  $\mu$ Mol, 400  $\mu$ Mol or 1100  $\mu$ Mol.
- Growth height at 3 LED layers: 490 mm.

\* PRC 600 WL, 1200 WL and 1200 SL: air cooled cooling system.

\*\* PRC1700 WL, 3200 WL: water cooled cooling system.

# Testimonials



This morning Plaxica received a new reactor lid (CG-1946-50) for our system to replace the one which we accidentally damaged.

I would like to thank GPE Scientific for organising a very quick turnaround on this item, it is now installed and ready to resume our research.

**Mike Dunning - Senior Chemist**

We received a professional technical support followed by precision made glass components which were all made within tight tolerances to our drawings within a few days after the order was placed.

Can anyone ask for more? the price was highly competitive too!  
A good supplier to work with.

**Uri Friedländer - UNO Boxer Pumps**

Many thanks for everyones help at GPE Scientific for the coaxial needle device you built for us earlier this year.

We have just had a paper on the device and its use published in a journal highly regarded in the microfluidic community, Lab on a Chip.

We also performed numerical simulations that matched the experimental measurements very well.

Again, we are extremely impressed and happy by the quality of the needles and the skill of your glass blowers.

**Paul Rademeyer - Oxford University**

After a long search looking for a replacement for our discontinued Jencons Autoburettes we were recommended GPE as a company who may be able to help.

After purchasing 4 of their 50ml Glass Autoburettes we were delighted to find they were everything our old Burettes were and more!

**Liam Palmer - Laboratory Manager**

We have purchased a number of complete Chemglass reactor systems from GPE Scientific over the years, including temperature control thermostats. They have provided a complete technical solution for us, including installation, training and commissioning of the reactor systems. They work in a highly efficient and professional manner and always respond to our queries in a timely manner.

GPE Scientific offer a complete pre and post sales support solution for our needs and provide regular refresher training sessions for all our staff when required. I would recommend them as a supplier of chemical reactor systems.

**Duncan Sinclair - Purolite**

GPE offer high quality lab glassware and the flexibility to create customised vessels and apparatus which suit our needs.

They come highly recommended to anyone who requires a special glassware design for their research.

**Colin Keyworth  
Process Development Manager**

GPE Scientific offer a wide range of products for the Chemistry, Life Science, Sustainable Solutions, Industrial Glass and Glassblowing Sectors.

The Chemistry and Life Science ranges are our largest sections, with over four thousand products online for you to browse and explore.

**Our aim is simple; to provide you with a full range of products to suit your needs, at the highest quality.**

Not only can you browse all the product information on our website, you can download brochures and technical documents, watch videos and even checkout online to receive a quotation just for you!

**WWW.GPESCIENTIFIC.CO.UK**

